

CASSONETTO RESTAURO

1 - Il sistema cassonetto in PVC restauro, prodotto e commercializzato da **Area Serramenti**, si caratterizza per le eccellenti proprietà di isolamento termico e acustico, l'eleganza e la modularità della soluzione.

2 - Il profilo è strutturato in due camere e presenta una guarnizione co-estrusa per una maggiore tenuta e qualità. Il cassonetto è proposto in due varianti costruttive, determinate dalla presenza o dall'assenza dell'elemento isolante in polistirene espanso. Grazie alla semplice struttura a due profili, eccelle in versatilità e possibilità d'impiego: l'esecuzione può essere personalizzata a seconda delle necessità, in funzione delle diverse profondità ed esigenze di installazione.

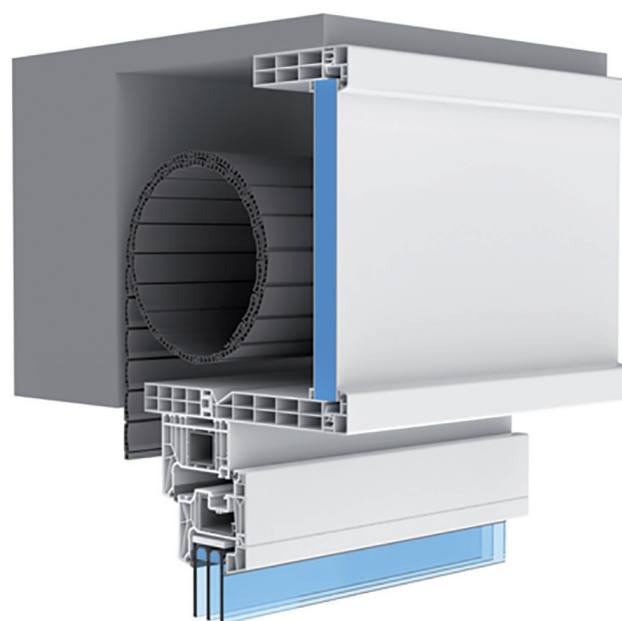
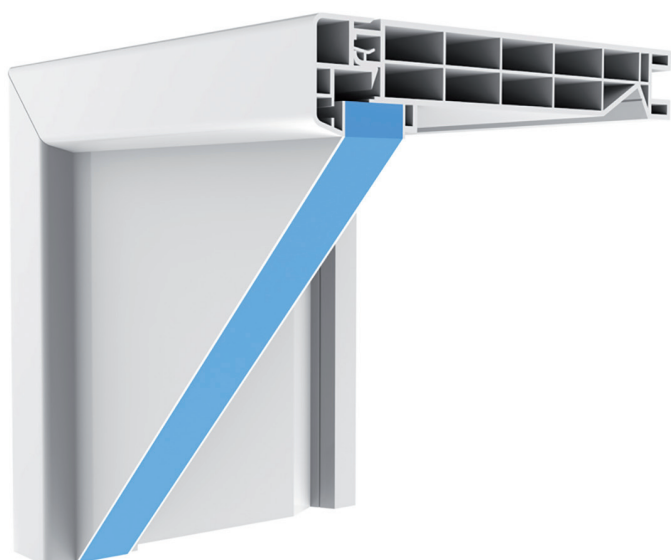

	Schüco Cassonetto restauro	Schüco Cassonetto restauro ridotto
Dimensioni		
Profondità del profilo principale	135 mm	55 mm
Possibile spessore del pannello	24 mm	24 mm
Possibile spessore isolante interno	8 mm – 20 mm	8 mm – 20 mm
Test		
Trasmittanza termica a norma EN ISO 10077-2:2017 (massimo) *	U _{sb} = 0,98 W/(m²K)	U _{sb} = 0,98 W/(m²K)
Isolamento acustico a norme UNI EN ISO 10140-2:2010 e UNI EN ISO 717-1:2013 (massimo) *	R _w = 40 dB	R _w = 40 dB
Resistenza al vento calcolata secondo la scala Beaufort	2000 Pa	2000 Pa

* A seconda del pannello e del materiale isolante.

CASSONETTO STANDARD

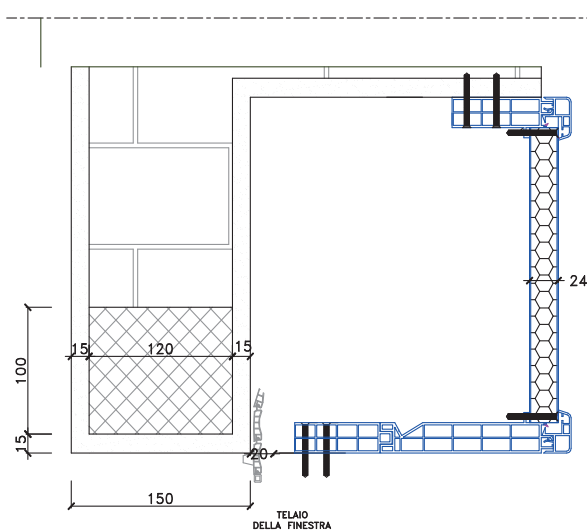

Versione standard da 24 mm.

CASSONETTO CON ISOLANTE

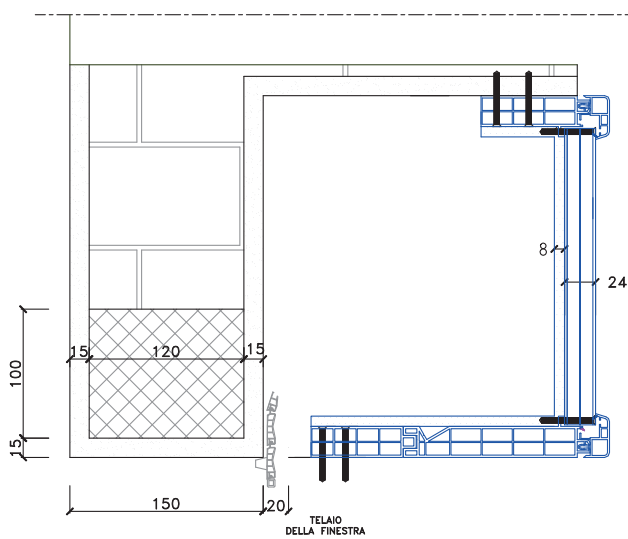

Versione da 24 mm. con isolante termico da 8 mm

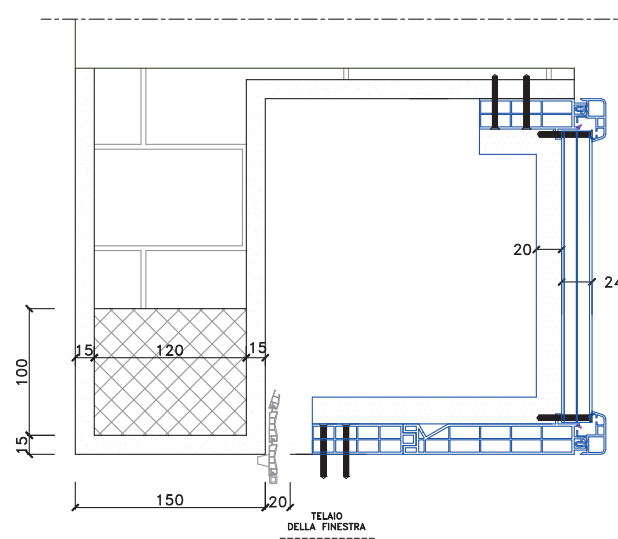

Versione da 24 mm. con isolante termico da 20 mm

Risultati della prova sui cassonetti con isolante termico

Il valore di trasmittanza termica del cassetto calcolato secondo la norma EN ISO 10077-2 risulta:

Denominazione del cassetto	Altezza del cassetto "b _{sb} " [mm]	Trasmittanza termica "U _{sb} " [W/(m ² · K)]
Cassonetto Schüco PVC con doga da 24 mm e isolante da 8 mm	281	1,3
Cassonetto Schüco PVC con doga da 24 mm e isolante da 20 mm	281	0,98

PROFILI CASSONETTO E PROLUNGHE

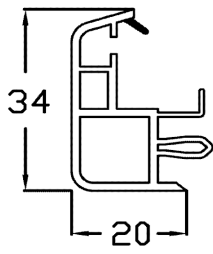

Ferma Pannello

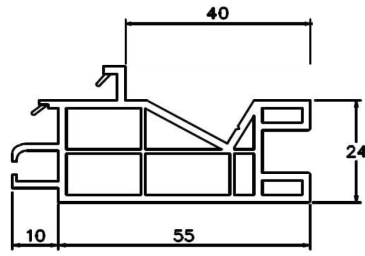

Profilo principale cassonetto ridotto

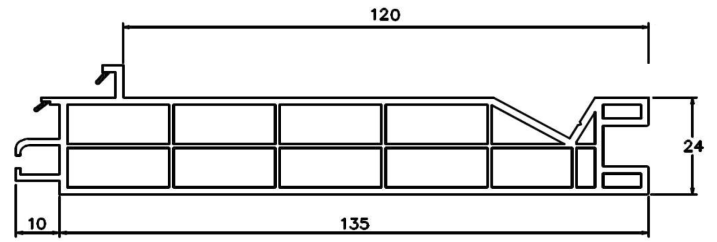

Profilo principale cassonetto standard

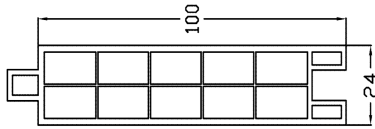

Profilo doga cassonetto

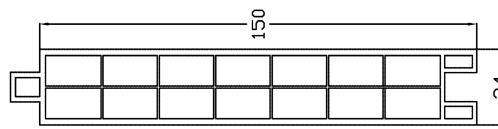

Profilo doga cassonetto



Utensile apertura coperchio

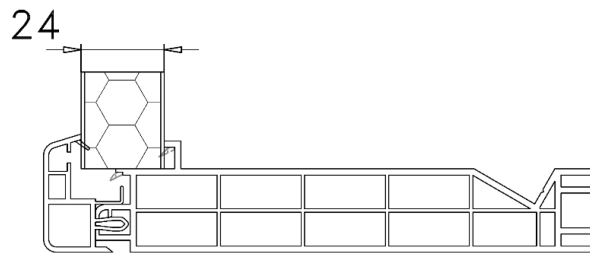

Misure pannello

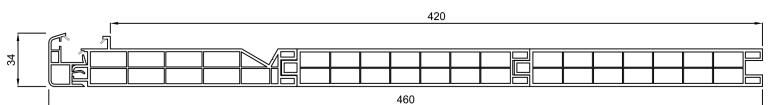
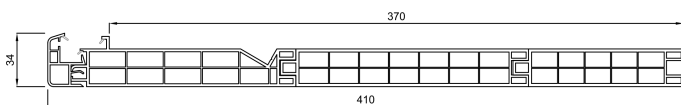
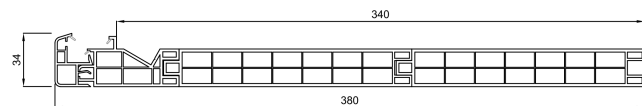
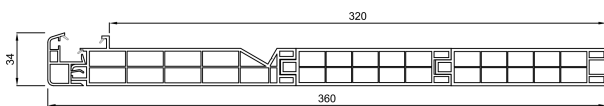
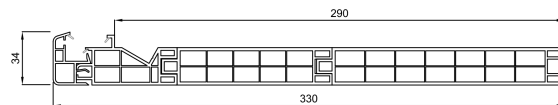
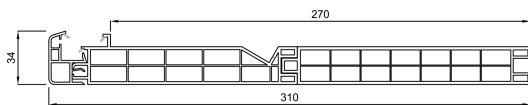
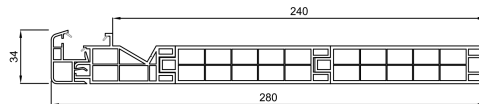
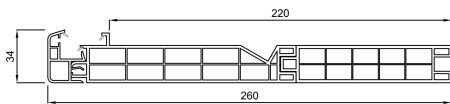
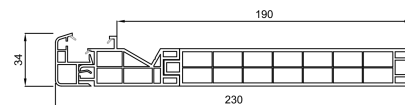
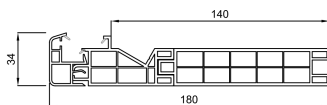
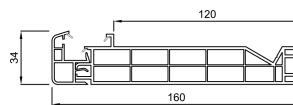
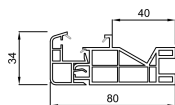

Prolunghe

PROFILI COMPLEMENTARI

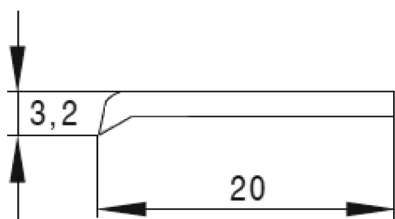

67S20 - Piatta senza biadesivo da 20 x 3 mm.

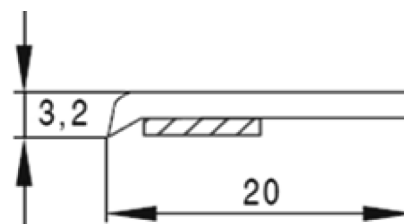

67020 - Piatta con biadesivo da 20 x 3 mm.

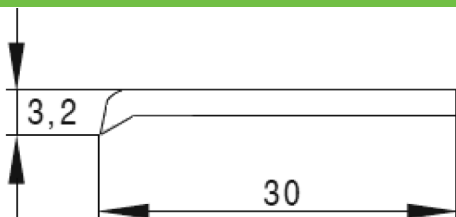

67S30 - Piatta senza biadesivo da 30 x 3 mm.

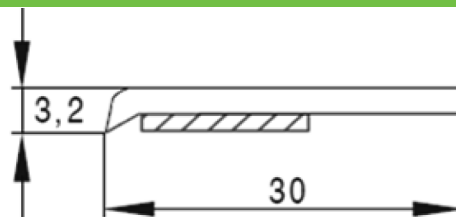

67030 - Piatta con biadesivo da 30 x 3 mm.

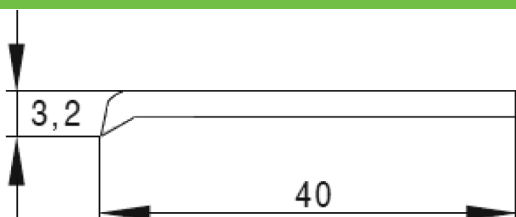

67S40 - Piatta senza biadesivo da 40 x 3 mm.

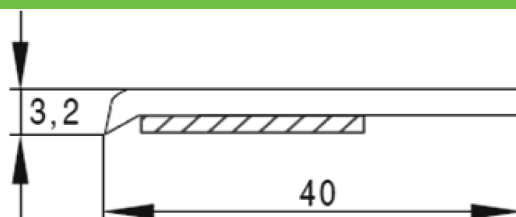

67040 - Piatta con biadesivo da 40 x 3 mm.

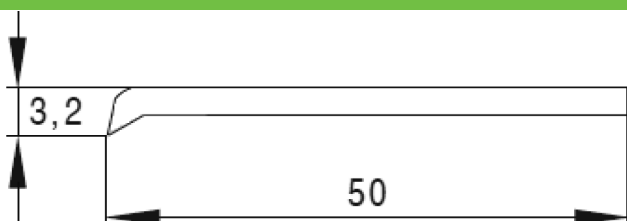

67S50 - Piatta senza biadesivo da 50 x 3 mm.

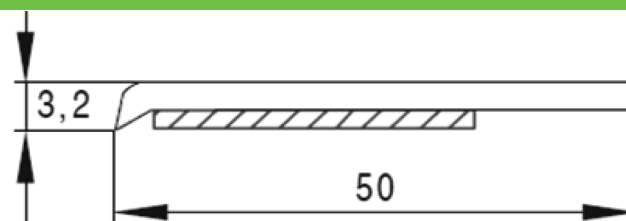

67050 - Piatta con biadesivo da 50 x 3 mm.

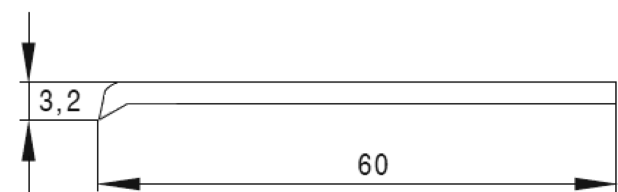

67S60 - Piatta senza biadesivo da 60 x 3 mm.

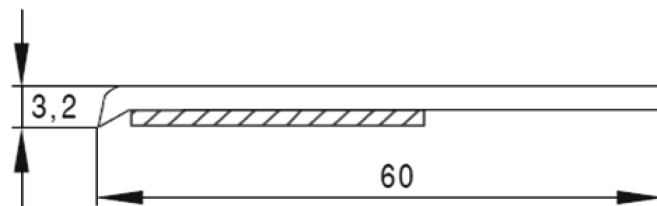

67060 - Piatta con biadesivo da 60 x 3 mm.

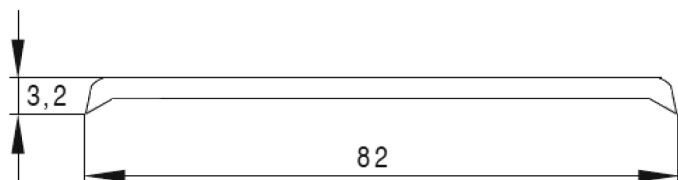

67S82 - Piatta senza biadesivo da 82 x 3 mm.

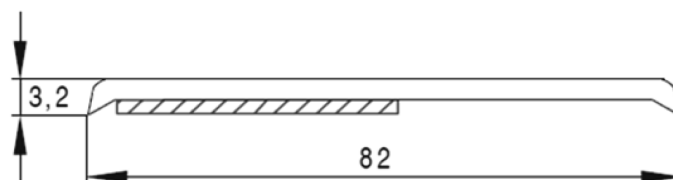

67082 - Piatta con biadesivo da 82 x 3 mm.

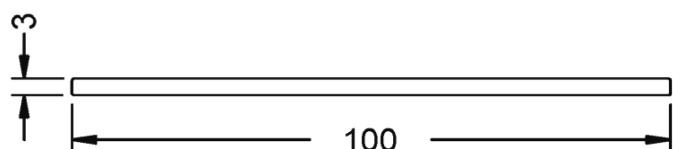

17165 - Piatta senza biadesivo da 100 x 3 mm.

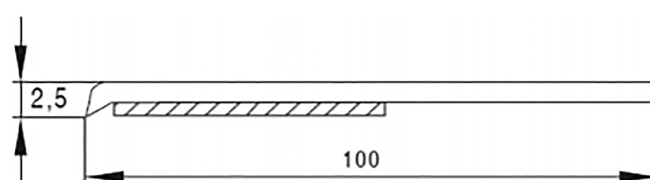

19300 - Piatta con biadesivo da 100 x 3 mm.

PROFILI COMPLEMENTARI

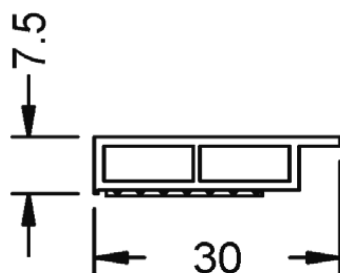

17710 - Profilo scatolato con biadesivo 30/7,5

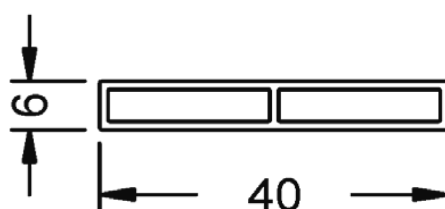

171171 - Profilo scatolato senza biadesivo 40/6

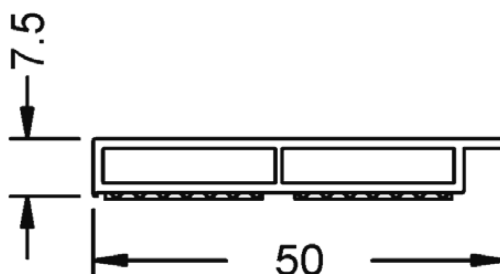

18737 - Profilo scatolato con biadesivo 50/7,5

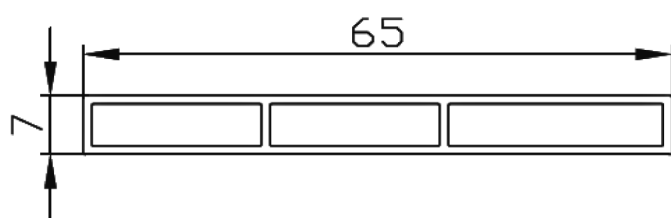

67S65 - Profilo scatolato senza biadesivo 65/7

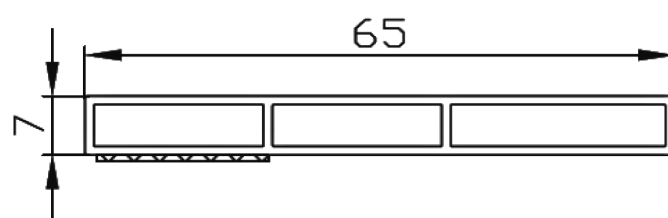

67065 - Profilo scatolato con biadesivo 65/7

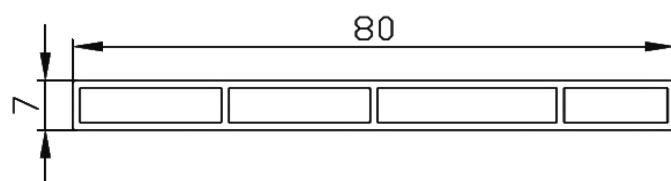

67S80 - Profilo scatolato senza biadesivo 80/7

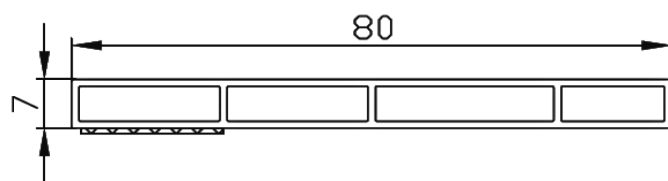

67080 - Profilo scatolato con biadesivo 80/7

PROFILI COMPLEMENTARI

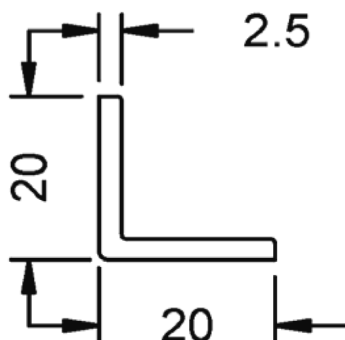

18781 - Profilo angolare da 20/20/2,5 mm.

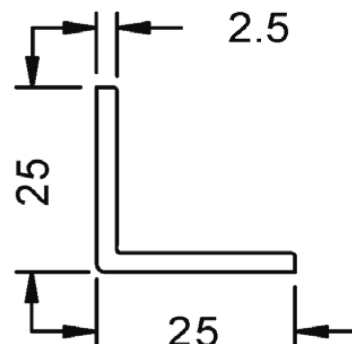

19306 - Profilo angolare da 25/25/2,5 mm.

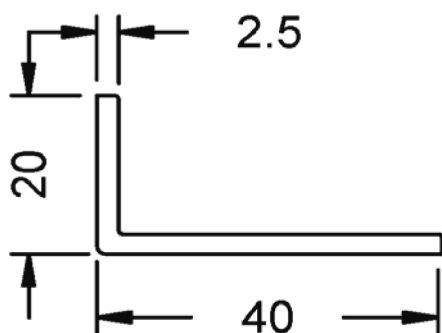

19307 - Profilo angolare da 40/20/2,5 mm.

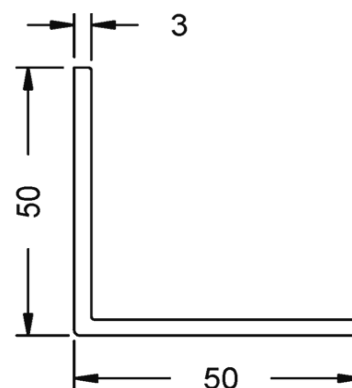

17170 - Profilo angolare da 50/50/3 mm.

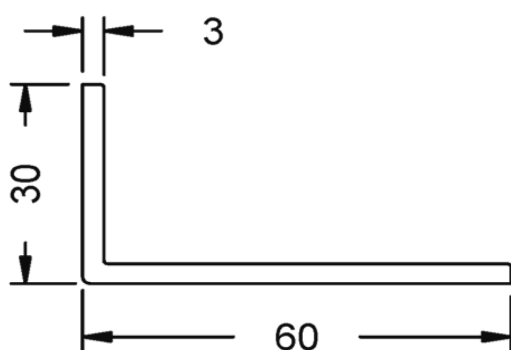

18398 - Profilo angolare da 60/30/3 mm.

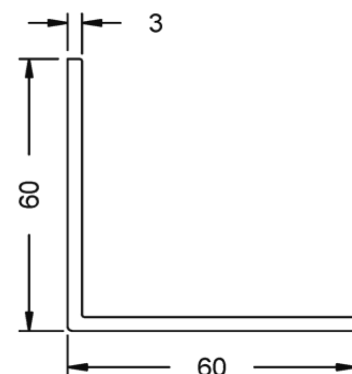

18784 - Profilo angolare da 60/60/3 mm.

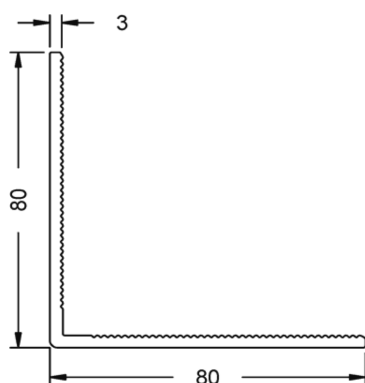

18475 - Profilo angolare da 80/80/3 mm.

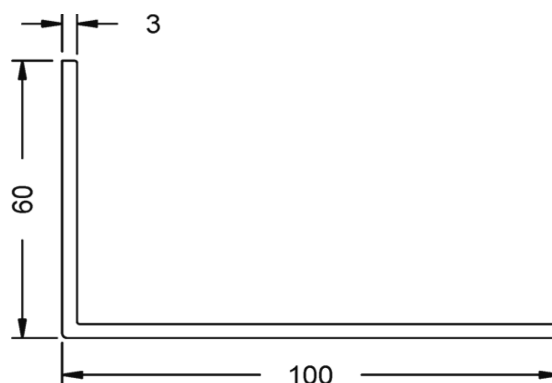

18399 - Profilo angolare da 100/60/3 mm.

PROFILI COMPLEMENTARI

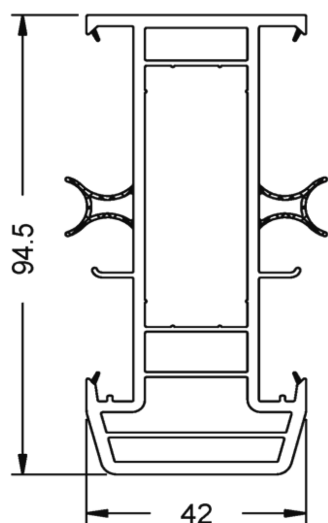

19211 - Profilo Lesena 94,5/42 Classic 70

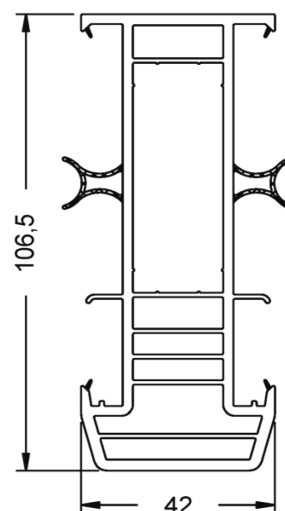

19212- Profilo Lesena 106,5/42 Living 82

LATO INTERNO

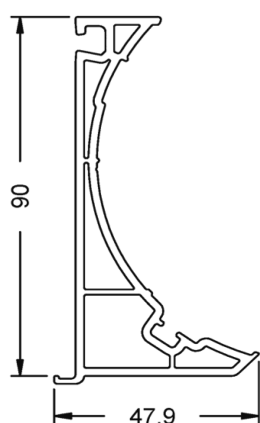

LATO ESTERNO

19830 - Profilo di accoppiamento angolo variabile Classic 70 e Living 82

LATO INTERNO

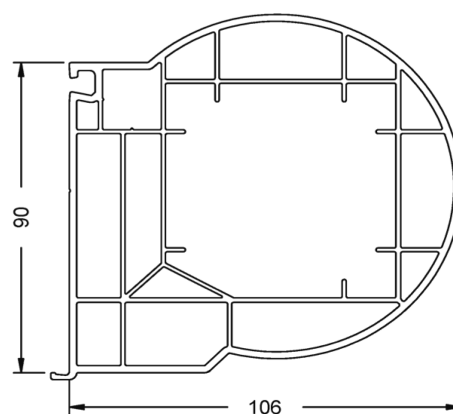

LATO ESTERNO

19831 - Profilo di accoppiamento angolo variabile Classic 70 e Living 82

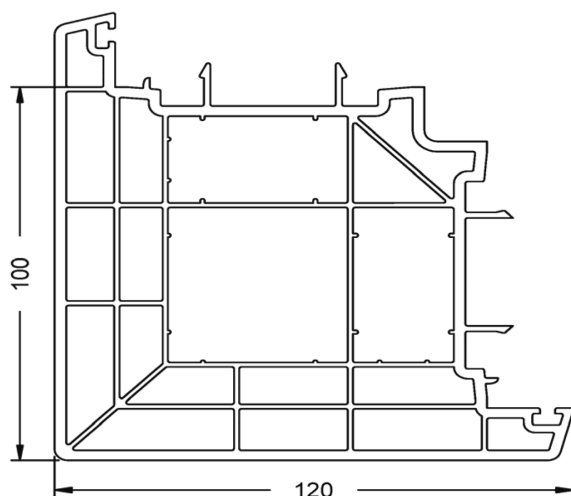

18485 - Profilo di accoppiamento 120 mm Angolo 90° Classic 70 e Living 82

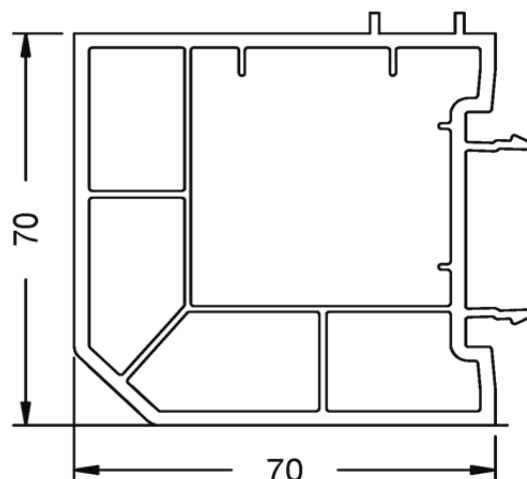

18579 - Profilo di accoppiamento 70 mm Angolo 90° Classic 70

PROFILI COMPLEMENTARI

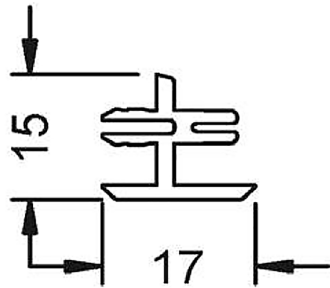

18423 - Profilo di accoppiamento 15/17

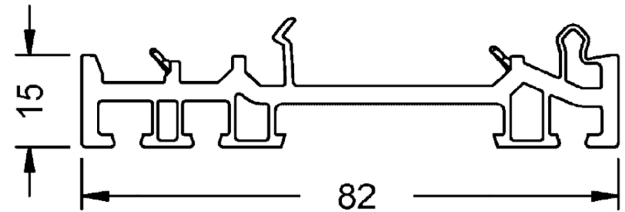

19366 - Allargatore 82/15

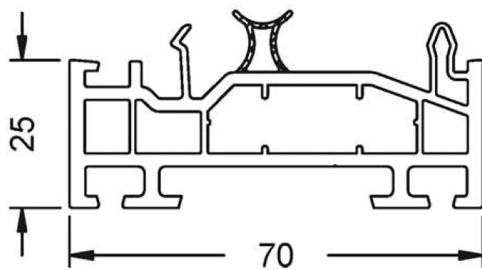

19841 - Allargatore 70/25

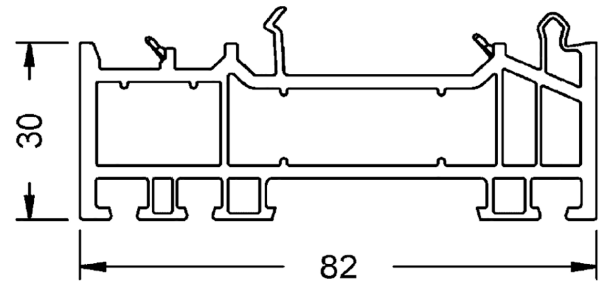

19367 - Allargatore 82/30

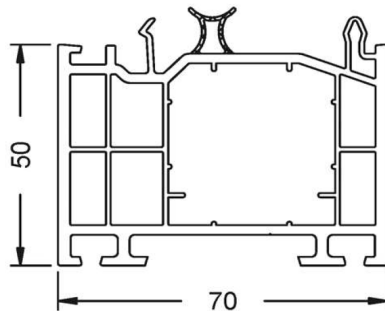

19842 - Allargatore 70/50

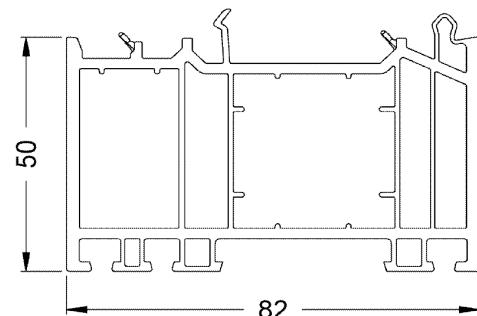

19368 - Allargatore 82/50

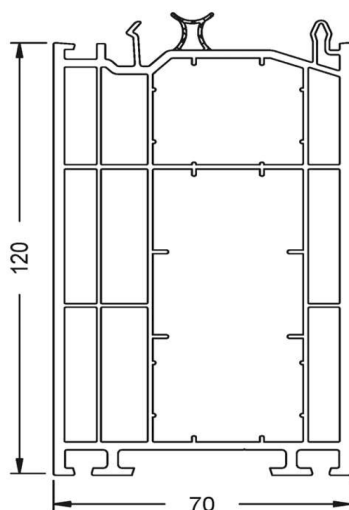

19843 - Allargatore 70/120

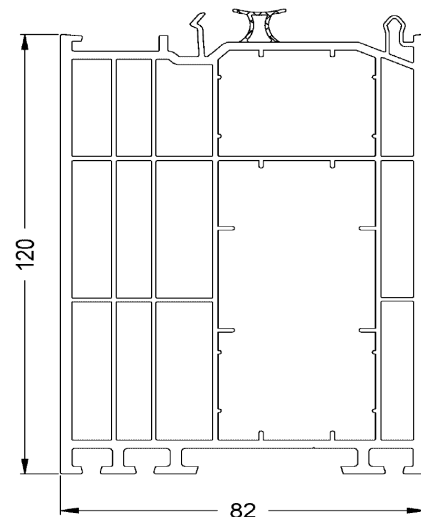

19258 - Allargatore 82/120

PROFILI COMPLEMENTARI

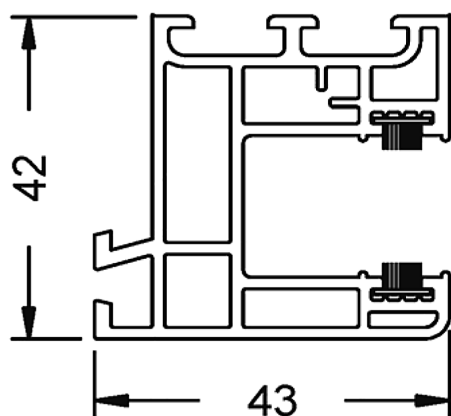

19151 - Guida avvolgibile 42/43

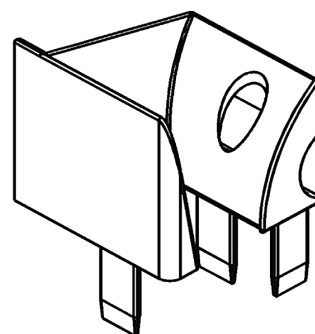

28625800 - Tappo terminale nero
28625800 - Tappo terminale bianco

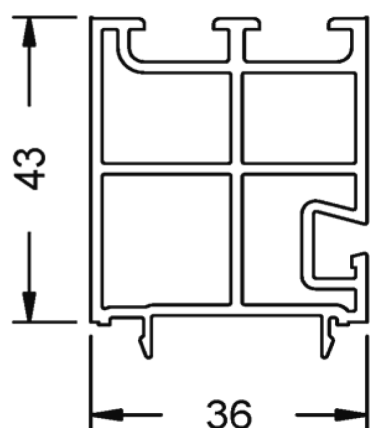

18029 - Adattatore guida avvolgibile 43/36 per 19151

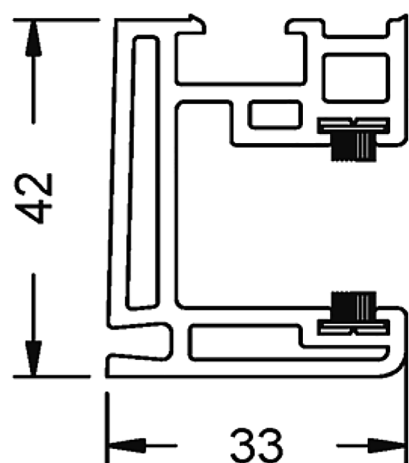

18486 - Guida avvolgibile 42/33

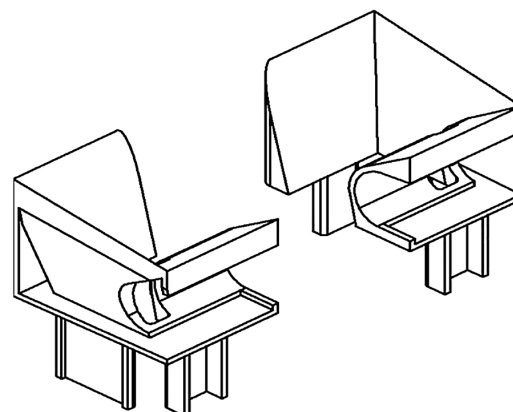

23735500 - Tappo terminale nero
23735700 - Tappo terminale bianco